

EVENT-BROTHER

SB Series Crowd Control Barrier

Aluminum crowd control barrier for staging show project. It is widely used to keep the audience from the actors and maintain a safety distance from the stage performers. Constructed by premium material, the production is characterized for easy to carry and stock, save shipping space. It is convenient to assemble and disassemble, fast set up and labor-saving. The step panel is anti-slip design to protect people from slip even though in a moistured weather.



Engineering Specification

Model No.: SB-02

Material: International standard 6061-T6

Dimension: L:1000xH:1200mmX

W:1250mm

Tube Spec.: 50*43*2mm

Vice tube: 43*30*2mm,

Aluminum Sheet: 3mm

Weight: 26.2Kg

Packaging: Transport Cart/Carton

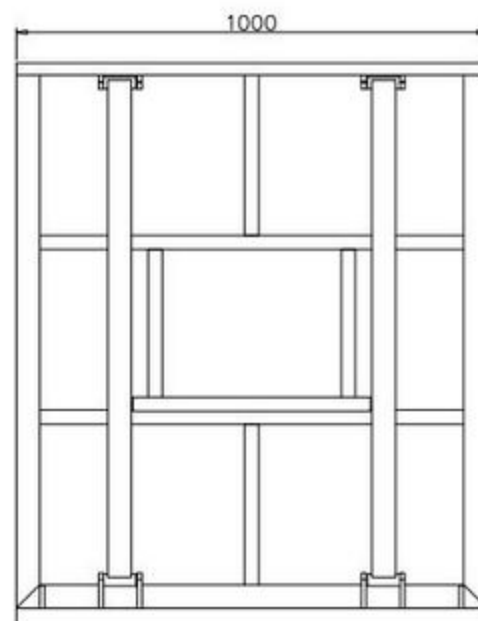
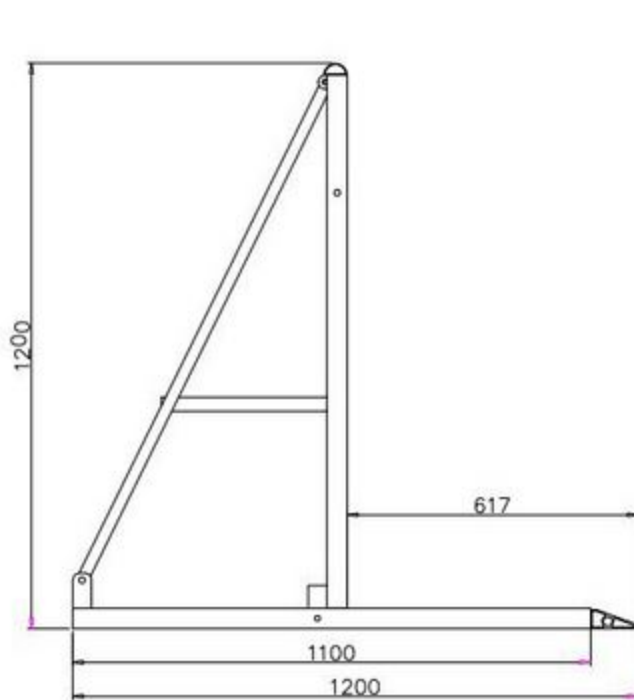



Engineering Specification

Model No.: SB-02C
Material: International standard 6061-T6
Dimension: L:1200xH:1200mm
W:1250mm
Tube Spec.: 50*43*2mm
Vice tube: 43*30*2mm,
Aluminum Sheet: 3mm
Weight: 26Kgs
Packaging: Transport Cart/Carton



SB-02C enables $0^{\circ} \sim 45^{\circ}$ turnable for forming angel requirements in site operation

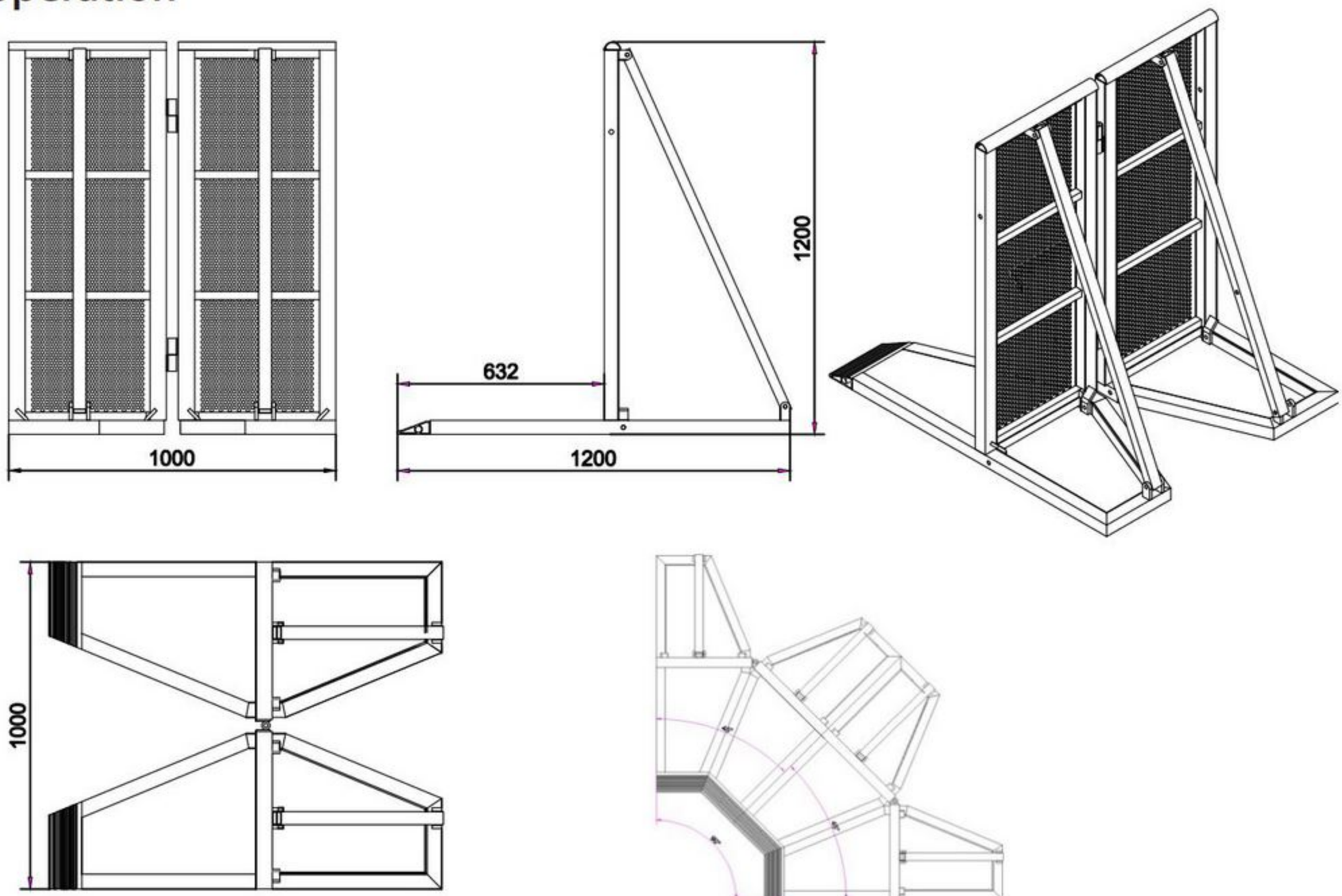

SB Series Crowd Control Barrier



Engineering Specification

Model No.: SB-02CA

Material: International standard 6061-T6

Dimension: L:1000xH:1200mmX

W:1250mm

Tube Spec.: 50*43*2mm

Vice tube: 43*30*2mm,

Aluminum Sheet: 3mm

Weight: 27Kgs

Packaging: Transport Cart/Cartron

